

# Creating Compass Courses

N

## Tools Needed:

Graph Paper

Protractor

Scale Ruler

E

To begin, decide on a scale ( $1/4'' = 1$  ft) and label graph paper N,S,E,W.

S

W

# Creating Compass Courses

N

Select a starting point.

E

S

W

Free Plain Graph Paper from <http://compact.com/graphpaper/plain/>

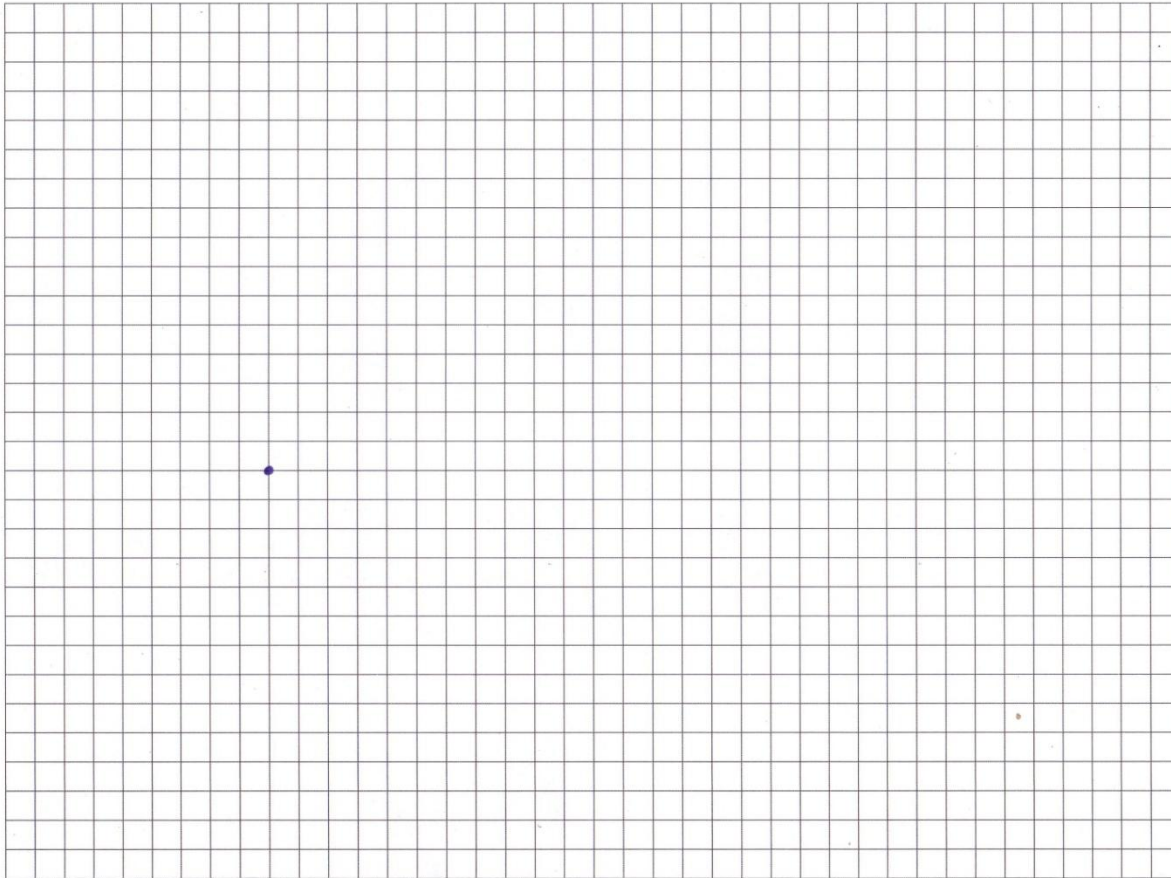

# Creating Compass Courses

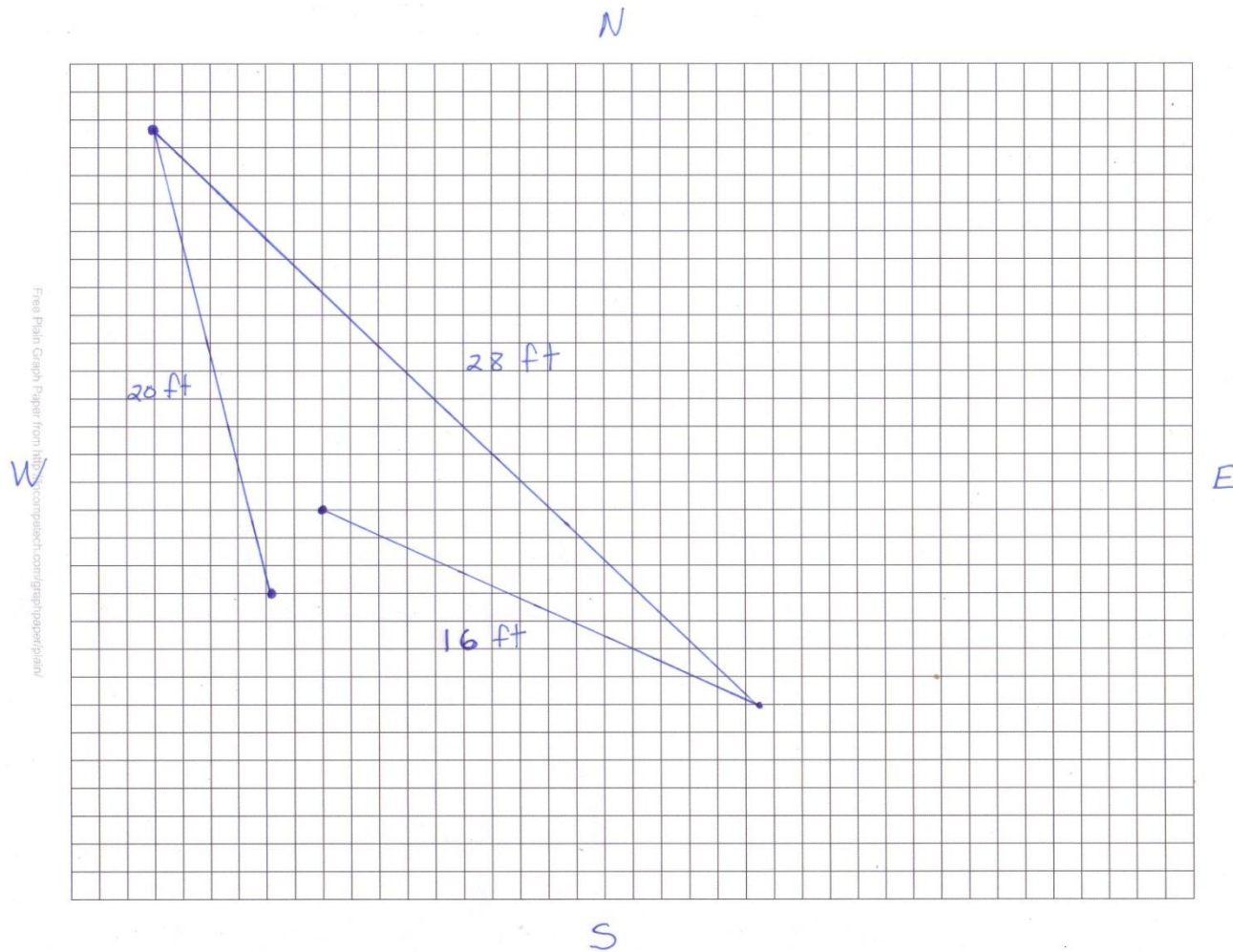

Select three points on the graph paper and draw lines between them for the course of travel. Using a scale ruler, measure the distance between points to determine the distance.

# Creating Compass Courses

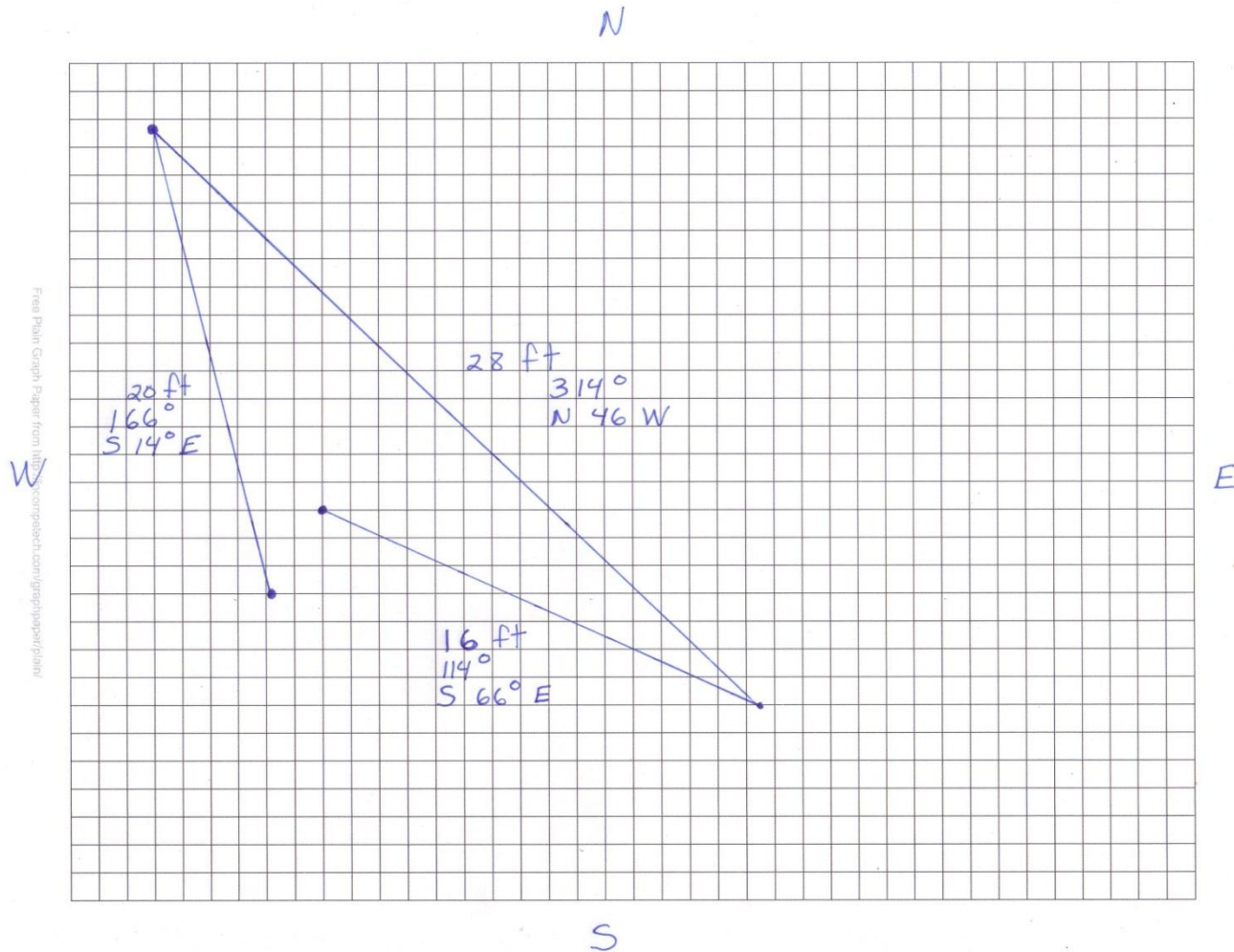

Using a protractor and a few basic math skills determine the direction of travel from starting point to point 2, 3 and ending point

# Creating Compass Courses

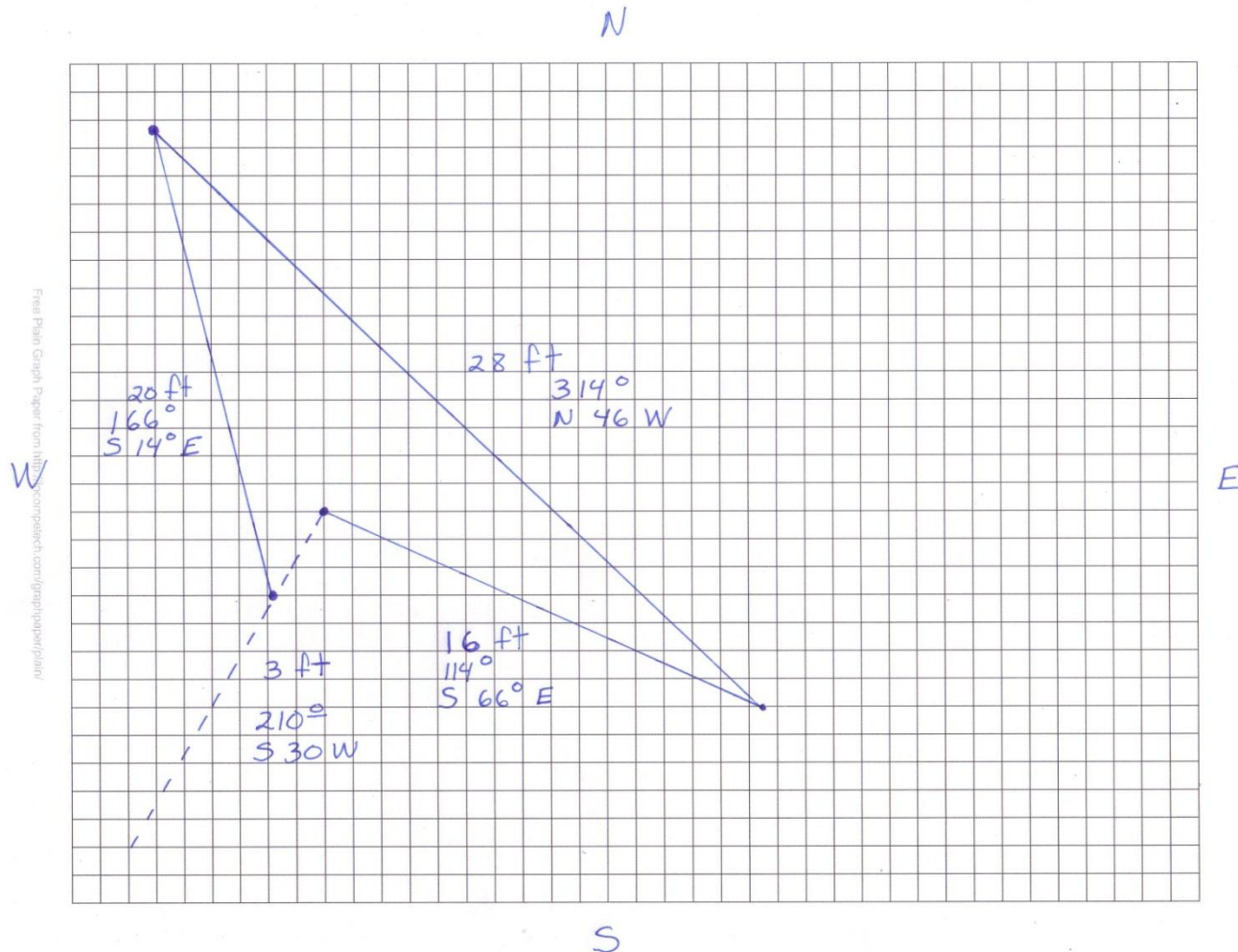

Determine direction and distance from start point to ending point. Draw a line between the two points and use a ruler and protractor .



# Creating Compass Courses

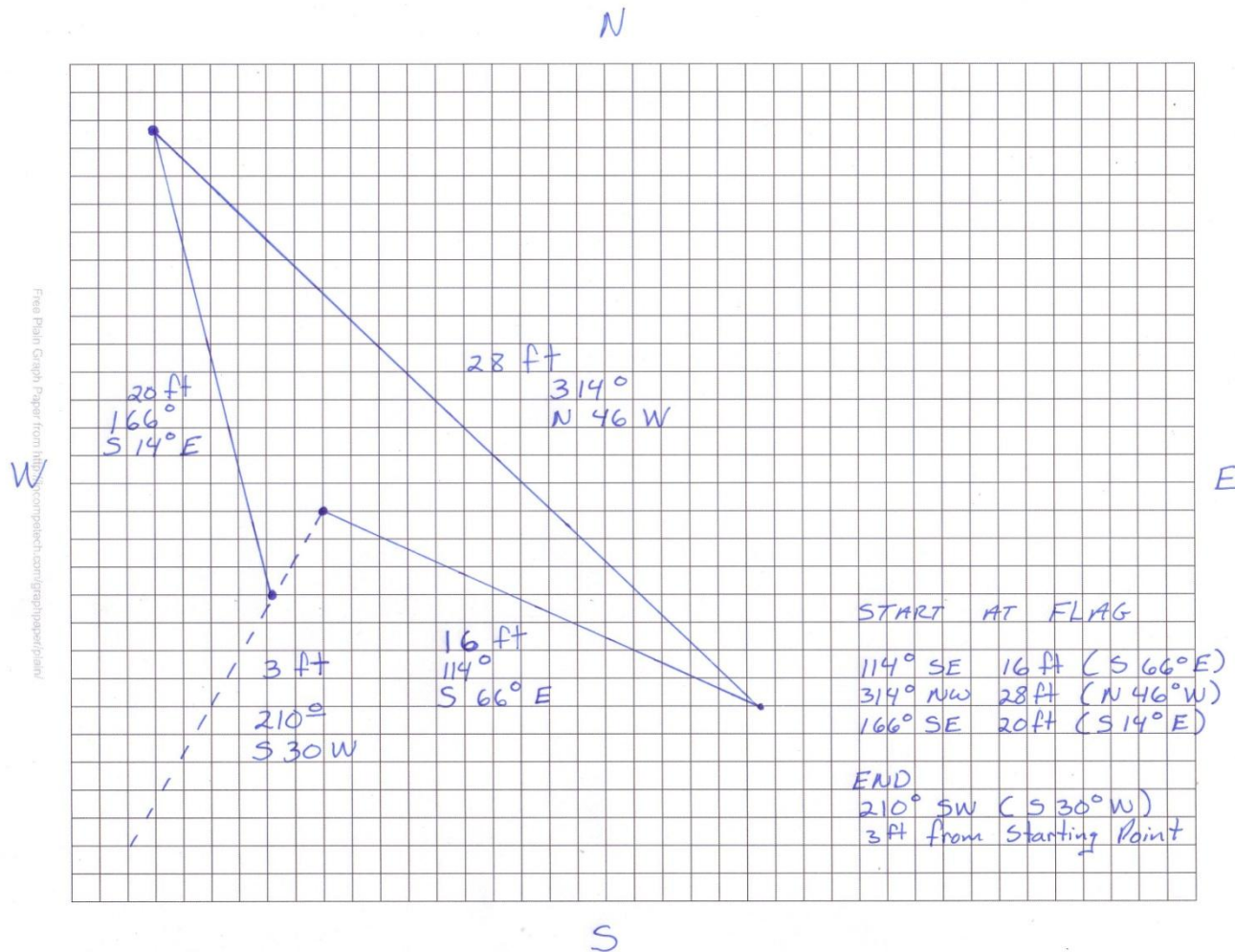

Transfer distances and direction of travel to cards for students. Use marking flags to establish a starting point and ending point in an open area.

Check their accuracy by measuring the distance between the starting and ending flag and the direction the ending flag is from the starting flag.